

JIG VGU

JIG VGU TEMPLATES

- The JIG VGU and JIG VGU TOTAL templates are essential tools for pre-drilling or pilot hole creation for the precise and aligned installation of 9, 11 and 13 mm VGS screws in their respective VGU washers
- **JIG VGU**: for exclusive use with the VGU washer, essential in all applications where it is welded to the plate (e.g. SPIDER)
- **JIG VGU TOTAL** is the evolution of the system: it does not require the VGU washer to create the pilot hole, making it ideal even in awkward situations or with limited space



1 JIG VGU



2 JIG VGU TOTAL

JIG VGU TEMPLATES

CODE	washer [mm]	d _v [mm] [in]	pcs
1 JIGVGU945	VGU945	5 0.197	1
2 JIGVGU945T		5 0.197	1
1 JIGVGU1145	VGU1145	6 0.236	1
2 JIGVGU1145T		6 0.236	1
1 JIGVGU1345	VGU1345	8 0.315	1
2 JIGVGU1345T		8 0.315	1

d_v = pre-drilling hole diameter

LOCKING RING FOR HSS BITS

CODE	d _{int} [mm] [in]	d _{ext} [mm] [in]	pcs
F2108005	5 0.197	10 0.394	10
F2108006	6 0.236	12 0.472	10
F2108008	8 0.315	16 0.630	10

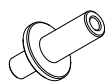

JIG VGU

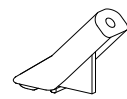
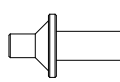

JIG VGU TOTAL

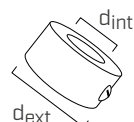

d_{ext}

VGU WASHER

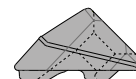

CODE	screw [mm]	d _{v,s} [mm] [in]	pcs
VGU945	VGS Ø9	5 0.197	25
VGU1145	VGS Ø11	6 0.236	25
VGU1345	VGS Ø13	8 0.315	25

d_{v,s} = pre-drilling hole diameter (softwood)

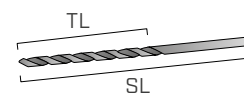

HSS WOOD DRILL BITS

CODE	d _v [mm] [in]	TL [mm] [in]	SL [mm] [in]	pcs
F1599105	5 0.197	150 6	100 4	1
F1599106	6 0.236	150 6	100 4	1
F1599108	8 0.315	150 6	100 4	1

d_v = pre-drilling hole diameter

For pilot hole compatible bits, refer to page 240.

For more information, see the **TIMBER SCREWS AND DECK FASTENING** catalogue, available in the "Catalogues" section of the website www.rothoblaas.com.

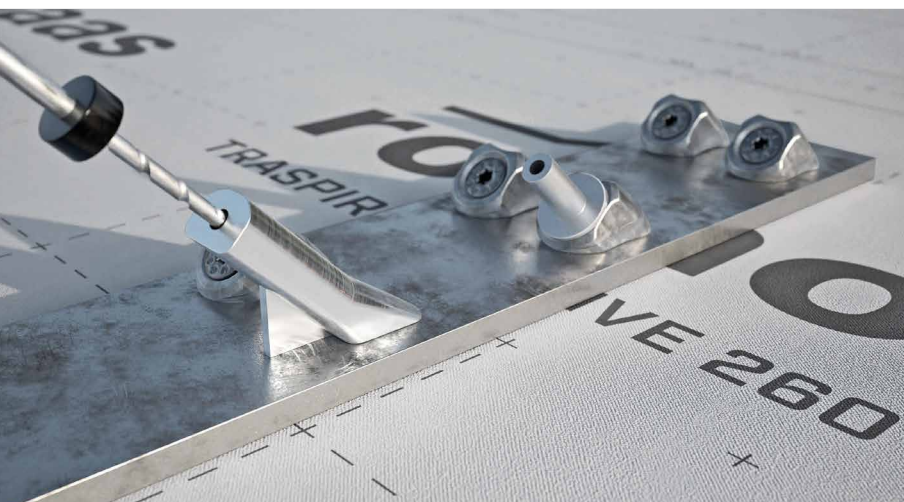

GUIDED 45° PRE-DRILLING

A pre-drill depth of at least 50 mm is recommended.

PRECISE PREDRILLING MADE EASY

Thanks to the new shape of the JIG VGU TOTAL, the jig can be easily held in place and precise pre-drilling is possible. Locking rings for the drill bits serve to ensure that all holes are pre-drilled to the same depth.