

# KOMPRI BAND

## SELF-EXPANDING SEALING TAPE

### CERTIFIED SOUNDPROOFING

Soundproofing up to 58 dB, certified by the IFT Rosenheim Institute.

### ELASTIC

Thanks its the special composition, it remains elastic and deformable over time, compensating for the movements of the wood and differential deformation of the building materials.

### HERMETIC

Airtight and watertight, it prevents possible acoustic bridges forming in the gaps between different building materials.

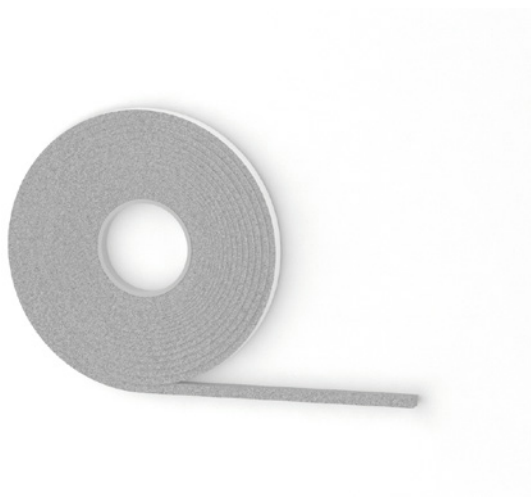

## CODES AND DIMENSIONS

code	B [mm]	L [m]	s <sub>max</sub> [mm]	f [mm]	pcs.
KOMPRI1010	10	13	10	1-4	30
KOMPRI1015	15	13	10	1-4	20
KOMPRI2015	15	8	20	4-10	20
KOMPRI3015	15	4,3	30	6-15	20
KOMPRI4520	20	3,3	45	9-20	15

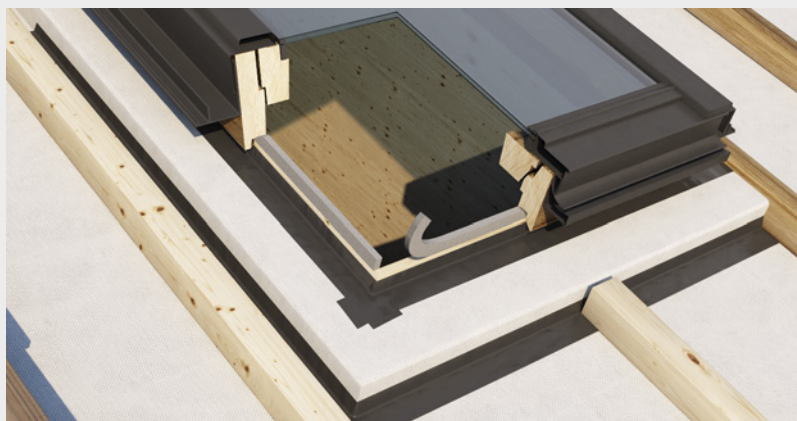

### < VERSATILE

Pre-compressed self-adhesive profile compatible with the most common building materials. Wide range to effectively seal cracks between 1 and 20 mm over time.

### MATERIAL

Pre-compressed polyurethane foam tape impregnated with fireproof substances.

## TECHNICAL SPECIFICATIONS

Property	Standard	Value
Classification	DIN 18542	class BG1 and BGR
Gap air passage coefficient (application B1)	EN 12114	$\alpha < 1,0 \text{ m}^3/[\text{h} \times \text{m} \times (\text{daPa})^0]$
Gap air passage coefficient (application BGR)	EN 12114	$\alpha < 0,1 \text{ m}^3/[\text{h} \times \text{m} \times (\text{daPa})^0]$
Thermal conductivity ( $\lambda$ )	DIN 52612	0,052 W/mK
Water vapour resistance factor ( $\mu$ )	EN ISO 12572	$\leq 100$
Resistance to heavy rain	EN 1027	> 600 Pa
Resistance to UV rays and weather	DIN 53387	according to standard
Compatibility with other building materials	DIN 52453	according to standard
Dimensional tolerance	DIN 7715 T5 P3	according to standard
Reaction to fire	DIN 4102	class B1
Acoustic insulation $R_{ST,W} (C;Ctr)^{(1)}$	IFT Rosenheim	58 (-2 ; -6) dB
Temperature resistance	DIN 18542	-30 / +90 °C
Application temperature	-	$\geq +5 \text{ °C}$
Storage temperature	-	+1 / +20 °C
Presence of solvents	-	NO
VOC emissions	-	< 0,02 % (class A+)

## BG1 - BG2 - BGR SELF-EXPANDING TAPES

Self-expanding tapes are products generally obtained from expanded polyurethane foam.

They are ideal for filling in irregular cracks that need to maintain high elasticity over time.

Expansion times depend on the temperature at the work site. Providing excellent thermal-acoustic insulation, they can be more or less resistant to water vapour and heavy rain.

DIN 18542:2009 identifies the fields of application for self-expanding tapes, classifying them into 3 categories:

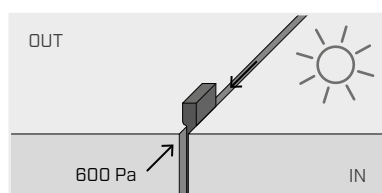

### BG1

Suitable for external use, including exposure to UV rays. Permeable to vapour. Creates an impermeable junction for pressures exceeding 600 Pa.

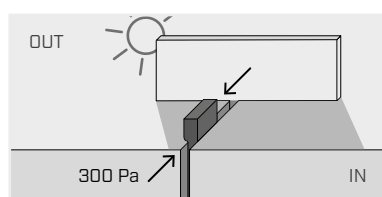

### BG2

Suitable for external use, if not directly exposed to UV rays. Permeable to vapour. Creates an impermeable junction for pressures exceeding 300 Pa.

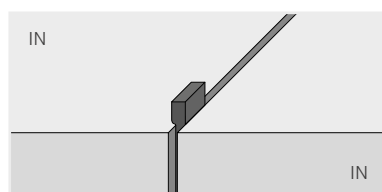

### BGR

Not suitable for external use. Impermeable to air and vapour.

#### NOTES:

Store the product in a dry location, indoors, max. 24 months.

<sup>(1)</sup> Test performed with two coupled tapes on a 10 mm wide crack